

Rotary Valve Instruments

French Horns



Bb Single French Horn CHR 330



V.F.Cervený Bb French Horn CHR 330

3 valves, yellow brass, bore 11.7mm, bell 305mm, nickel-silver trimmings, lacquer, silver-plated mouthpiece # 11, injection molded case # 6649.

Available Options:

X - Minibal Linkage Action.

R - Bell Rim.

M - Nickel-silver Mouthpipe.

Last Update October2005

CHR 330

Parts

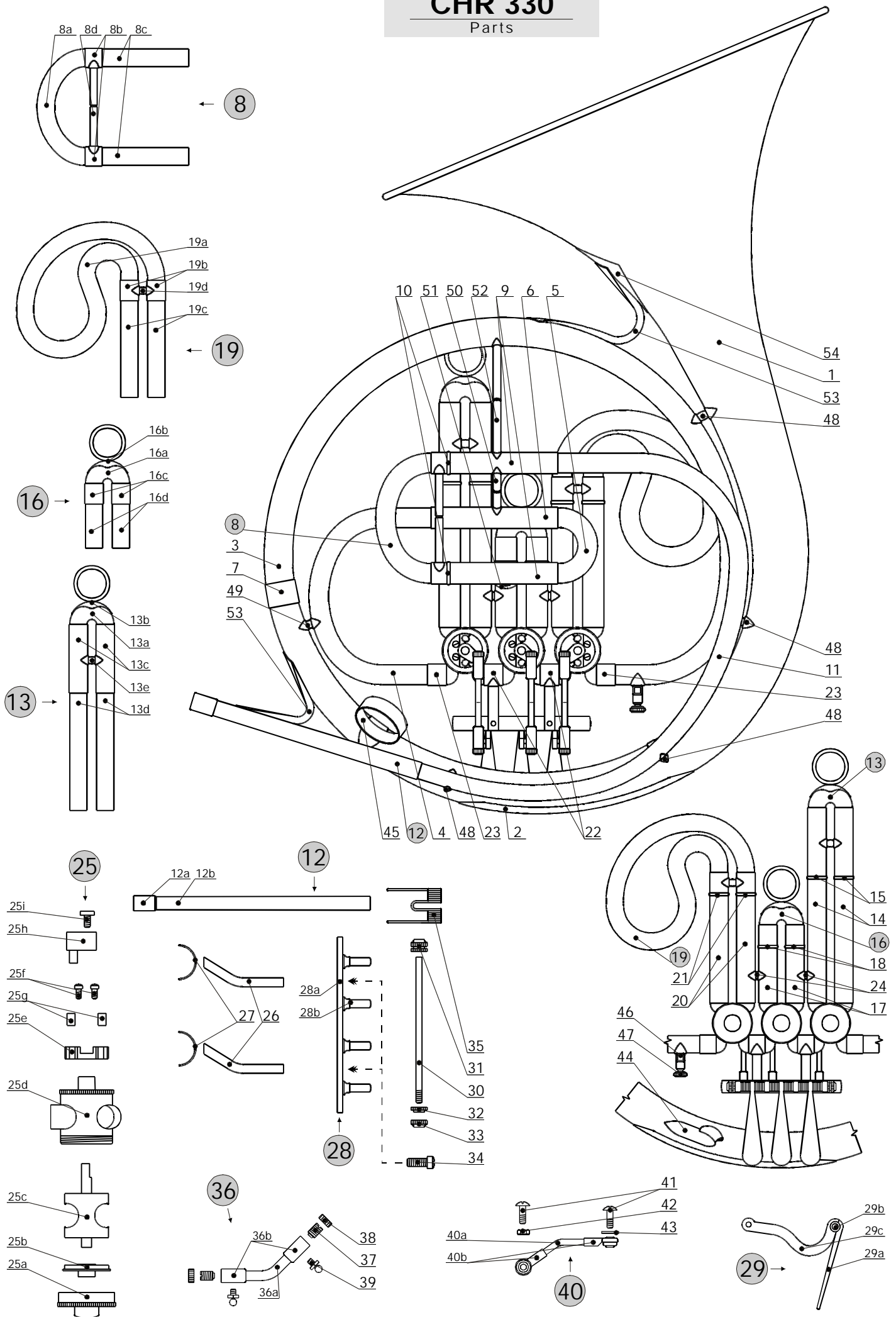

Parts For V.F.Cerveny Bb French Horn CHR 330.

List #	Part #	Description	Note
1	OZV 321HR L	Bell.	
	OZV 321HR KL	Bell complete with Guard.	
2	KAPNA OZV 321HR L	Bell Guard.	
3	DH 131 L	Branch I.	
4	DH 189 L	Crook.	
5	O 089 L	Bow.	
6	THA 088 P3 L	Connecting Tubing.	
7	SK LR 20/15 L	Connecting Ferrule, Bell - to - Branch I.	
8	LS 330HR K	Tuning Slide complete, lacquer.	<i>Outer Tubing to be ordered separately.</i>
8a	O 096 L	Tuning Slide Bow.	
8b	HTA 010 P3 L	Tuning Slide Ferrule (1 of 2pcs).	
8c	THE 070 P3 L	Tuning Slide Inner Tubing (1 of 2pcs).	
8d	A GX 0550D PP L	Tuning Slide Brace with Plates.	
9	THA 070 P3 L	Tuning Slide Outer Tubing (1 of 2pcs).	
10	H 237 L	Tuning Slide Outer Tubing Ring (1 of 2pcs).	
11	DH 190 L	Mouthpipe, brass.	
	DH 227 L	Mouthpipe, nickel-silver.	
12	U 330 HR L	Mouthpipe Overpart	
12a	K LR L	Mouthpipe Overpart End Ring.	
12b	D 183 L	Mouthpipe Overpart Tubing.	
**	ESO 330HR ML	Mouthpipe complete, brass (List # 11-12).	
**	ESO 330HR PL	Mouthpipe complete, nickel-silver (List # 11-12).	
13	SN 330HR 1K	1st Slide complete, lacquer.	<i>Outer Tubing to be ordered separately.</i>
13a	O 007 L	1st Slide Crook.	
13b	H 059H L	1st Slide Pull Ring with Plate.	
13c	HTA 050 P3 L	1st Slide Ferrule (1 of 2pcs).	
13d	THE 128 P3 L	1st Slide Inner Tubing (1 of 2pcs).	
13e	A GX 0050B PP L	1st Slide Brace with Plates.	
14	THA 092 P3 L	1st Slide Outer Tubing (1 of 2pcs).	
15	H 237 L	1st Slide Outer Tubing Ring (1 of 2pcs).	
16	SN 330HR 2K	2nd Slide complete, lacquer.	<i>Outer Tubing to be ordered separately.</i>
16a	O 007 L	2nd Slide Crook.	
16b	H 059H L	2nd Slide Pull Ring with Plate.	
16c	HTA 015 P3 L	2nd Slide Ferrule (1 of 2pcs).	
16d	THE 042 P3 L	2nd Slide Inner Tubing (1 of 2pcs).	
17	THA 042 P3 L	2nd Slide Outer Tubing (1 of 2pcs).	
18	H 237 L	2nd Slide Outer Tubing Ring (1 of 2pcs).	
19	SN 330HR 3K	3rd Slide complete, lacquer.	<i>Outer Tubing to be ordered separately.</i>
19a	D 011 L	3rd Slide Crook.	
19b	HTA 015 P3 L	3rd Slide Ferrule (1 of 2pcs).	
19c	THE 080 P3 L	3rd Slide Inner Tubing (1 of 2pcs).	
19d	A GX 0050B PP L	3rd Slide Brace with Plates.	
20	THA 080 P3 L	3rd Slide Outer Tubing (1 of 2pcs).	
21	H 237 L	3rd Slide Outer Tubing Ring (1 of 2pcs).	
22	K 3K L	Connecting Ferrule (1st Valve Casing - to - 2nd Valve Casing).	
		Connecting Ferrule (2nd Valve Casing - to - 3rd Valve Casing).	
23	K 3D L	Connecting Ferrule at the Valve Casing sides (1 of 2pcs).	
24	A GX 0010B PP L	Brace with Plates, 1st Slide - to - 2nd Slide.	
		Brace with Plates, 2nd Slide - to - 3rd Slide.	
25	VENTIL 003 MK 1/2 L	1st/2nd Rotary Valve Assy.	
	VENTIL 003 MK 3 L	3rd Rotary Valve Assy.	
25a	S 355	Bottom Cap, lacquer.	
25b	S 354 H	Rotary Valve Bearing.	
25c	VC 003MC H	Rotary Valve.	
25d	VCP 003MC ML	Rotary Valve Casing.	
25e	L 087	Stop Plate, lacquer.	
25f	S 669	Stop Plate Retaining Screw (1 pf 2pcs), lacquer.	
25g	SNURA 5	Bumper (length 1cm).	<i>SNURA PR.5 = Bumper (length 1meter).</i>
25h	T 268	Stop Arm, lacquer.	
25i	S 434	Stop Arm Retaining Screw, lacquer.	
**	MENIC 003MC ML	Rotary Valve with Casing, lapped (List # 25b-25d).	
**	SC 330HR L	Valve Casing Assy. complete with Slides and Rotary Valves, (List # 13-25).	
26	P 335 L	Lever Bridge Support (1 of 2pcs).	
27	P 336 L	Lever Bridge Support Plate (1 of 2pcs).	
28	P 112 K	Lever Bridge Assy., lacquer.	

28a	P 112 L	Lever Bridge.	
28b	S 659 L	Lever Bridge Post (1 of 4pcs).	
29	RA LR HOL	Finger Lever Assy., lacquer.	
29a	N 054 L	Finger Lever Plate.	
29b	TX2*17.1 L	Finger Lever Rod.	
29c	N 032N L	Finger Lever Linkage.	
30	OSA HOL 321HR	Rod Screw.	
31	S 034P H	Rod Screw End Nut.	
32	S 021P H	Rod Screw Retaining Nut, small.	
33	S 022P H	Rod Screw Retaining Nut, large.	
**	TL HOL 321HR	Lever Assy., lacquer (List # 28-33).	
34	S 050P L	Lever Bridge Retainung Screw (1 of 2pcs).	
35	PRUZ HOL LR	Lever Spring (1 of 3pcs).	
36	P 644/2	2nd/3rd Valve Linkage complete (type Standard), lacquer.	
	P 644/1	1st Valve Linkage complete (type Standard), lacquer.	
36a	S 638 L	Linkage Rod.	
36b	S 633 L	Linkage Bearing (1 of 2pcs).	
37	S 282P H	Linkage Screw (1 of 2pcs).	
38	S 280 H	Linkage Screw Nut (1 of 2pcs).	
39	S 632	Ball Pivot (1 of 2pcs).	
40	P 644X/2	2nd/3rd Valve Linkage complete (type Minibal).	
	P 644X/1	1st Valve Linkage complete (type Minibal).	
40a	P 644X L	Linkage Rod.	
40b	MINIBAL GK6-3 L	Minibal (1 of 2pcs).	
41	S 121P L	Minibal Screw (1 of 2pcs).	
42	S 123P L	Minibal Screw Nut (Lever Side).	
43	MINIBAL DORAZ	Minibal Screw Bumper (Stop Arm side).	
**	TL HOL 321HR K	Lever Assy. complete with linkages, lacquer (List # 28-39).	
	TL HOL 321HR XK	Lever Assy. complete with Minibal linkages, lacquer (List # 28-35, 40-43).	
44	F 003 L	Pinky Hook.	
45	H 091 L	Thumb Ring with Plate.	
46	T 033P L	Cardholder Socket with Plate.	
47	S 040	Cardholder Screw, lacquer.	
48	A LX 0020B PP L	Brace with Plates (1 of 4pcs).	<i>Brace Length to be specified.</i>
49	A GX 0020B PP L	Brace with Plates, Bell - to - Crook.	<i>Brace Length to be specified.</i>
50	A GX 0200D PP L	Brace with Plates, Tuning Slide - to - Connecting Tubing.	<i>Brace Length to be specified.</i>
51	A GX 0300D PP L	Brace with Plates, Tuning Slide - 2nd Slide.	<i>Brace Length to be specified.</i>
52	A GX 0750D PP L	Brace with Plates, Branch I - to - Tuning Slide.	<i>Brace Length to be specified.</i>
53	P 393 L	Brace, Bell - to - Branch I.	
		Brace, Bell - to - Mouthpipe Overpart.	
54	P 175P L	Plate, large.	

Important:

1/ All metal parts polished and unlacquered, unless otherwise specified. Please specify desired finish, when ordering.

2/ Please indicate the Instrument's Model Number, when ordering.