

Rotary Valve Instruments

French Horns



F/Eb Single French Horn CHR 321



V.F.Cervený F/Eb French Horn CHR 321

3 valves, yellow brass, bore 11.7mm, bell 305mm, nickel-silver mouthpipe & trimmings, lacquer, extra Eb tuning slide, silver-plated mouthpiece # 11, injection molded case # 6649.

Available Options:

***X - Minibal Linkage Action.
R - Bell Rim.***

Last Update September2005

CHR 321

Parts

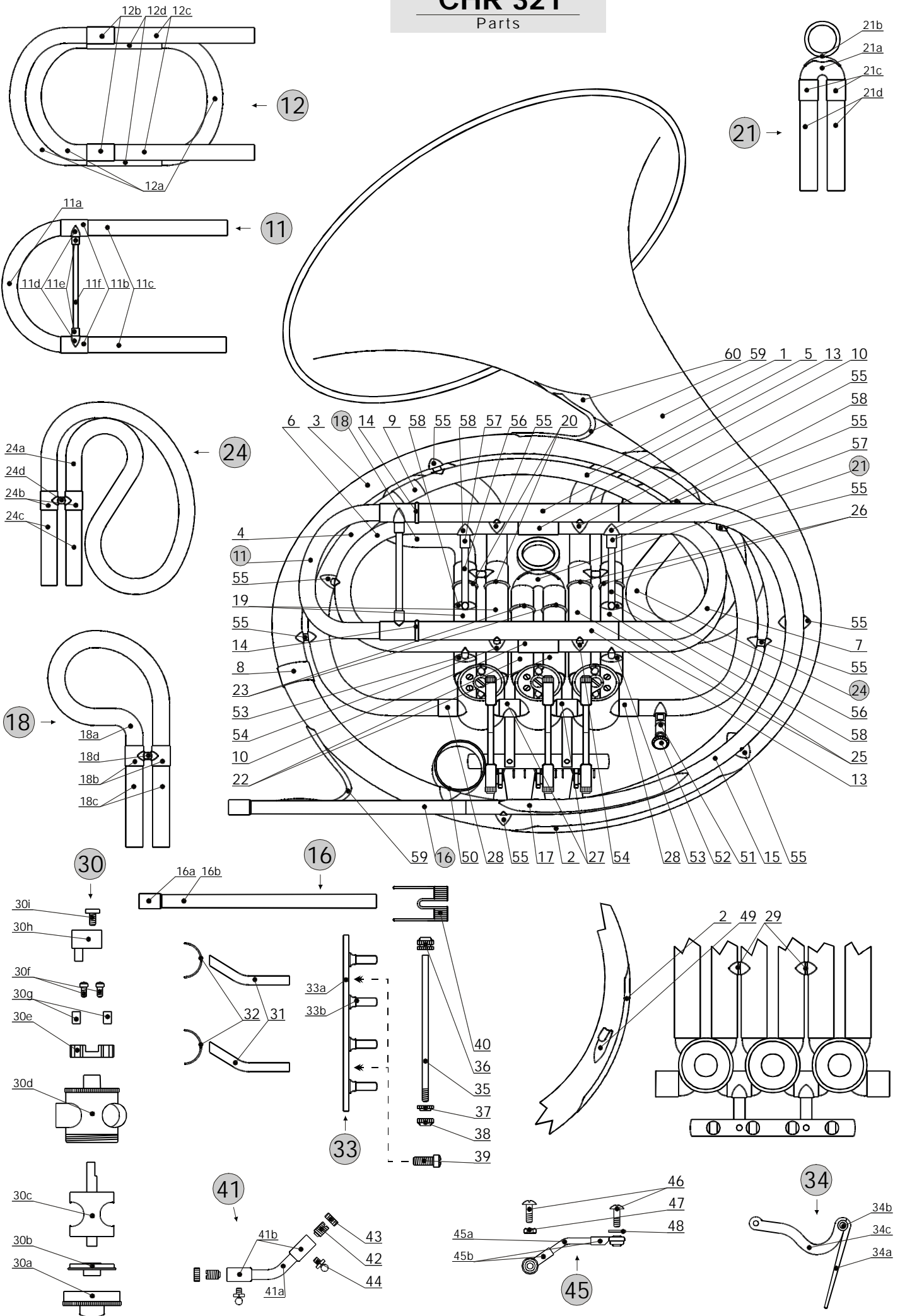

Parts For V.F.Cerveny F/Eb French Horn CHR 321.

List #	Part #	Description	Note
1	OZV 321HR L	Bell.	
	OZV 321HR KL	Bell complete with Guard.	
2	KAPNA OZV 321HR L	Bell Guard.	
3	DH 131 L	Branch I.	
4	DH 052 L	Branch II.	
5	DH 053 L	Branch III.	
6	D 016 L	Crook, large.	
7	D 016 AL	Crook, small.	
8	SK LR 20/15 L	Connecting Ferrule, Bell - to - Branch I.	
9	SK LR 13.5/15 L	Connecting Ferrule, Branch II - to - Branch III.	
10	SK LR 13.5/25 L	Connecting Ferrule, Branch III - to - large Crook.	
		Connecting Ferrule, large Crook - to - small Crook.	
11	LS 321HR K	F Tuning Slide complete, lacquer.	<i>Outer Tubing to be ordered separately.</i>
11a	O 097 L	F Tuning Slide Bow.	
11b	HTA 022 P3 L	F Tuning Slide Ferrule (1 of 2pcs).	
11c	THE 125 P3 L	F Tuning Slide Inner Tubing (1 of 2pcs).	
11d	P 243PD L	F Tuning Slide Brace Socket Plate (1 of 2pcs).	
11e	S 367 L	F Tuning Slide Brace Socket (1 of 2pcs).	
11f	TYC 073M PR4 L	F Tuning Slide Brace Rod.	
12	LS 321HR AK	Eb Tuning Slide complete, lacquer.	<i>Outer Tubing to be ordered separately.</i>
12a	O 100 L	Eb Tuning Slide Bow (1 of 3pcs).	
12b	HTA 022 P3 L	Eb Tuning Slide Ferrule (1 of 2pcs).	
12c	THE 125 P3 L	Eb Tuning Slide Inner Tubing (1 of 2pcs).	
12d	THA 060 P3 L	Eb Tuning Slide Connecting Tubing.	
13	THA 126 P3 L	F/Eb Tuning Slide Outer Tubing (1 of 2pcs).	
14	H 237 L	F/Eb Tuning Slide Outer Tubing Ring (1 of 2pcs).	
15	DH 138 L	Mouthpipe.	
16	U 321 HR L	Mouthpipe Overpart	
16a	K LR L	Mouthpipe Overpart End Ring.	
16b	D 169 L	Mouthpipe Overpart Tubing.	
17	KAPNA ESO 321 L	Mouthpipe Guard.	
**	ESO 321HR PL	Mouthpipe complete (List # 15-17).	
18	SN 321HR 1K	1st Slide complete, lacquer.	<i>Outer Tubing to be ordered separately.</i>
18a	D 015 L	1st Slide Crook.	
18b	HTA 014 P3 L	1st Slide Ferrule (1 of 2pcs).	
18c	THE 070 P3 L	1st Slide Inner Tubing (1 of 2pcs).	
18d	A GX 0050B PP L	1st Slide Brace with Plates.	
19	THA 094 P3 L	1st Slide Outer Tubing (1 of 2pcs).	
20	H 237 L	1st Slide Outer Tubing Ring (1 of 2pcs).	
21	SN 321HR 2K	2nd Slide complete, lacquer.	<i>Outer Tubing to be ordered separately.</i>
21a	O 007 L	2nd Slide Crook.	
21b	H 059H L	2nd Slide Pull Ring with Plate.	
21c	HTA 014 P3 L	2nd Slide Ferrule (1 of 2pcs).	
21d	THE 075 P3 L	2nd Slide Inner Tubing (1 of 2pcs).	
22	THA 075 P3 L	2nd Slide Outer Tubing (1 of 2pcs).	
23	H 237 L	2nd Slide Outer Tubing Ring (1 of 2pcs).	
24	SN 321HR 3K	3rd Slide complete, lacquer.	<i>Outer Tubing to be ordered separately.</i>
24a	D 012 L	3rd Slide Crook.	
24b	HTA 014 P3 L	3rd Slide Ferrule (1 of 2pcs).	
24c	THE 070 P3 L	3rd Slide Inner Tubing (1 of 2pcs).	
24d	A GX 0050B PP L	3rd Slide Brace with Plates.	
25	THA 094 P3 L	3rd Slide Outer Tubing (1 of 2pcs).	
26	H 237 L	3rd Slide Outer Tubing Ring (1 of 2pcs).	
27	K 3K L	Connecting Ferrule (1st Valve Casing - to - 2nd Valve Casing).	
		Connecting Ferrule (2nd Valve Casing - to - 3rd Valve Casing).	
28	K 3D L	Connecting Ferrule at the Valve Casing sides (1 of 2pcs).	
29	A GX 0010B PP L	Brace with Plates, 1st Slide - to - 2nd Slide.	
		Brace with Plates, 2nd Slide - to - 3rd Slide.	
30	VENTIL 003 MK 1/2 L	1st/2nd Rotary Valve Assy.	
	VENTIL 003 MK 3 L	3rd Rotary Valve Assy.	
30a	S 355	Bottom Cap, lacquer.	
30b	S 354 H	Rotary Valve Bearing.	
30c	VC 003MC H	Rotary Valve.	
30d	VCP 003MC ML	Rotary Valve Casing.	
30e	L 087	Stop Plate, lacquer.	

30f	S 669	Stop Plate Retaining Screw (1 pf 2pcs), lacquer.	
30g	SNURA 5	Bumper (length 1cm).	SNURA PR.5 = Bumper (length 1meter).
30h	T 268	Stop Arm, lacquer.	
30i	S 434	Stop Arm Retaining Screw, lacquer.	
**	MENIC 003MC ML	Rotary Valve with Casing, lapped (List # 30b-30d).	
**	SC 321HR L	Valve Casing Assy. complete with Slides and Rotary Valves, (List # 18-30).	
31	P 335 L	Lever Bridge Support (1 of 2pcs).	
32	P 336 L	Lever Bridge Support Plate (1 of 2pcs).	
33	P 112 K	Lever Bridge Assy., lacquer.	
33a	P 112 L	Lever Bridge.	
33b	S 659 L	Lever Bridge Post (1 of 4pcs).	
34	RA LR HOL	Finger Lever Assy., lacquer.	
34a	N 054 L	Finger Lever Plate.	
34b	TX2*17.1 L	Finger Lever Rod.	
34c	N 032N L	Finger Lever Linkage.	
35	OSA HOL 321HR	Rod Screw.	
36	S 034P H	Rod Screw End Nut.	
37	S 021P H	Rod Screw Retaining Nut, small.	
38	S 022P H	Rod Screw Retaining Nut, large.	
**	TL HOL 321HR	Lever Assy., lacquer (List # 33-38).	
39	S 050P L	Lever Bridge Retainung Screw (1 of 2pcs).	
40	PRUZ HOL LR	Lever Spring (1 of 3pcs).	
41	P 644/2	2nd/3rd Valve Linkage complete (type Standard), lacquer.	
	P 644/1	1st Valve Linkage complete (type Standard), lacquer.	
41a	S 638 L	Linkage Rod.	
41b	S 633 L	Linkage Bearing (1 of 2pcs).	
42	S 282P H	Linkage Screw (1 of 2pcs).	
43	S 280 H	Linkage Screw Nut (1 of 2pcs).	
44	S 632	Ball Pivot (1 of 2pcs).	
45	P 644X/2	2nd/3rd Valve Linkage complete (type Minibal).	
	P 644X/1	1st Valve Linkage complete (type Minibal).	
45a	P 644X L	Linkage Rod.	
45b	MINIBAL GK6-3 L	Minibal (1 of 2pcs).	
46	S 121P L	Minibal Screw (1 of 2pcs).	
47	S 123P L	Minibal Screw Nut (Lever Side).	
48	MINIBAL DORAZ	Minibal Screw Bumper (Stop Arm side).	
**	TL HOL 321HR K	Lever Assy. complete with linkages, lacquer (List # 33-44).	
	TL HOL 321HR XK	Lever Assy. complete with Minibal linkages, lacquer (List # 33-40, 45-48).	
49	F 003 L	Pinky Hook.	
50	H 091 L	Thumb Ring with Plate.	
51	T 033P L	Cardholder Socket with Plate.	
52	S 040	Cardholder Screw, lacquer.	
53	A AB 0090H PP L	Brace with Plates (1 of 2pcs).	Brace Length to be specified.
54	A AX 0070H PP L	Brace with Plates (1 of 2pcs).	Brace Length to be specified.
55	A AX 0020B PP L	Brace with Plates (1 of 11pcs).	
56	TYC 055M PR4 L	Brace Rod (1 of 2pcs).	
57	S 367 L	Brace Rod Socket (1 of 2pcs).	
58	P 093PD L	Brace Rod Plate (1 of 4pcs).	
59	P 393 L	Brace, Bell - to - Branch I.	
		Brace, Bell - to - Mouthpipe Overpart.	
60	P 175P L	Plate, large.	

Important:

1/ All metal parts polished and unlacquered, unless otherwise specified. Please specify desired finish, when ordering.

2/ Please indicate the Instrument's Model Number, when ordering.