

## Rotary Valve Instruments



Fluegelhorns

### **Bb Fluegelhorn CFH 502P**

*Pictured CFH 502PRX*



### **V.F.Cervený Bb Fluegelhorn CFH 502P**

**3 valves, yellow brass, bore 11.1mm, bell 160mm, 3rd Slide Trigger, 2 waterkeys, Nickel-silver Mouthpipe, Valve Casings & Trimmings, lacquer, silver-plated Fluegelhorn-mouthpiece # 1 1/2F, plastic case # 6708.**

#### **Available Options:**

**X - Minibal Linkage Action.**

**R - Bell Rim**

**CFH 702R - Red Brass Model**

**Last Update February 2005**

# CFH 502P

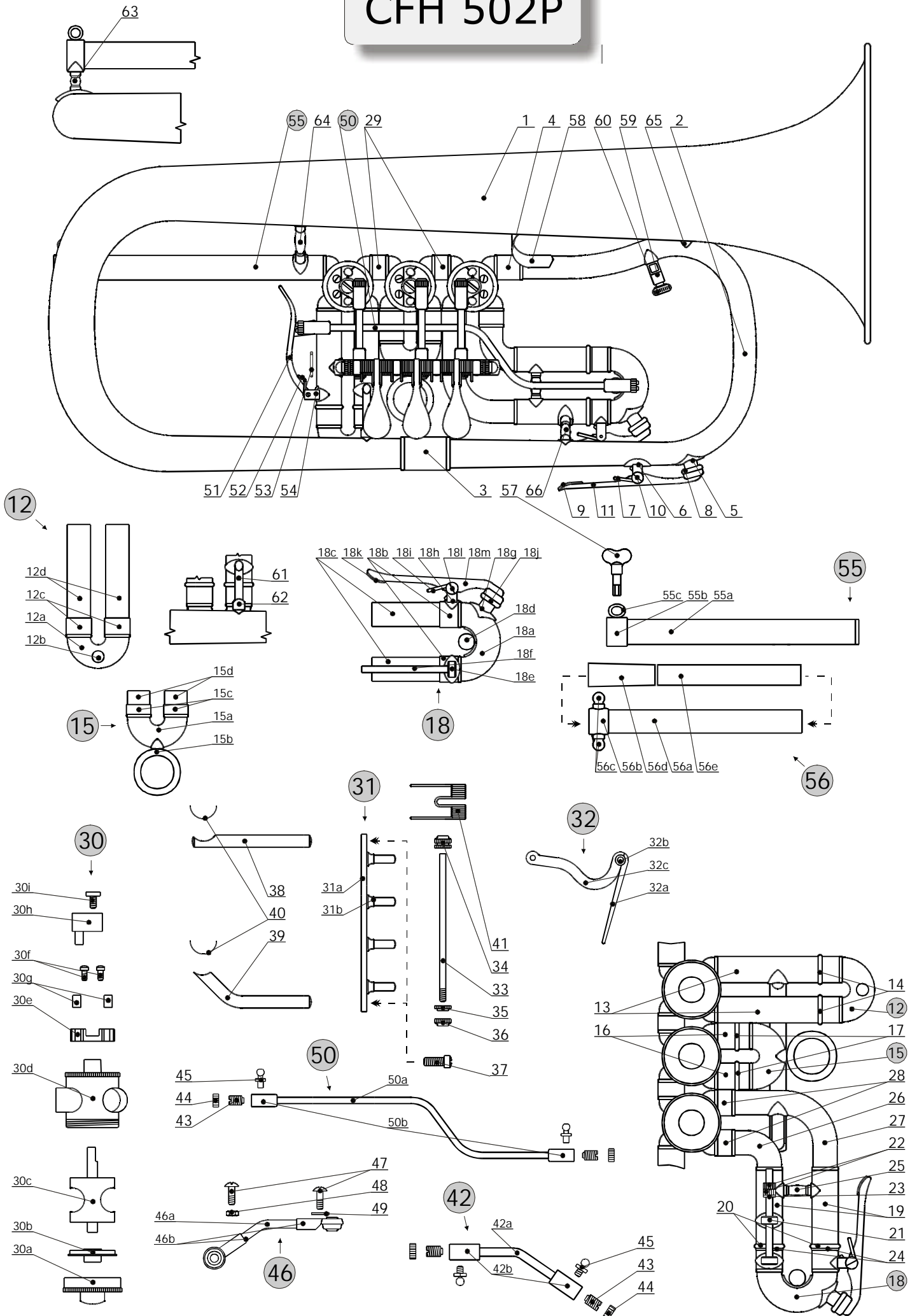

## Parts For V.F.Cerveny Bb Rotary Valve Fluegelhorn CFH 502P.

List #	Part #	Description	Note
1	OZV 502FH L	Bell, engraved with the 'V.F.Cerveny' Logo.	For CFH 502 Models.
	OZV 502FH RL	Bell with Rim, engraved with the 'V.F.Cerveny' Logo.	For CFH 502R Models.
2	D 179 L	Branch.	
3	S 159P Z2 L	Connecting Ferrule, Bell - to - Branch.	
4	SKA 015 P2 Z2 L	Connecting Ferrule, Branch - to - 3rd Valve Casing.	
5	T 347P L	Branch Waterkey Nipple with Plate.	
6	T 351P L	Waterkey Saddle with Plate.	
7	P 312	Waterkey Spring.	
8	KOREK VK 5*11*8	Waterkey Nipple Cork.	
9	KOREK 0.5*30*40	Waterkey Lever Cork.	
10	S 063AP	Waterkey Screw, lacquer.	
11	V 030 N	Branch Waterkey Lever, nickel-plated.	
**	V 030 KPN	Branch Waterkey Assy. complete (List # 7-11).	
12	SN 501TR 1PK	1st Slide complete, lacquer.	Outer Tubing to be ordered separately.
12a	O 004 L	1st Slide Bow.	
12b	S 004P L	1st Slide Bow Knob.	
12c	HTA 010 P2 Z1 L	1st Slide Ferrule (1 of 2pcs).	
12d	THE 053 P2 L	1st Slide Inner Tubing (1 of 2pcs).	
13	THA 053 P2 Z1 L	1st Slide Outer Tubing (1 of 2pcs).	
14	H 238P L	1st Slide Outer Tubing Ring (1 of 2pcs).	
15	SN 501TR 2PK	2nd Slide complete, lacquer.	Outer Tubing to be ordered separately.
15a	O 004 L	2nd Slide Bow.	
15b	H 056 L	2nd Slide Finger Ring with Plate.	
15c	HTA 006.5 P2 Z1 L	2nd Slide Ferrule (1 of 2pcs).	
15d	THE 010.5 P2 L	2nd Slide Inner Tubing (1 of 2pcs).	
16	THA 012 P2 Z1 L	2nd Slide Outer Tubing (1 of 2pcs).	
17	H 238P L	2nd Slide Outer Tubing Ring (1 of 2pcs).	
18	SN 502FH 3PK	3rd Slide complete, lacquer.	Outer Tubing to be ordered separately.
18a	O 061 L	3rd Slide Bow.	
18b	HTA 010 P2 Z1 L	3rd Slide Ferrule (1 of 2pcs).	
18c	THE 039 P2 L	3rd Slide Inner Tubing (1 of 2pcs).	
18d	T 368P L	3rd Slide Trigger Linkage Holder with Plate.	
18e	T 047 PP L	3rd Slide Trigger Guide Rod Screw Holder with Plate.	
18f	S 253P H	3rd Slide Trigger Guide Rod Screw.	
**	T 048A PP L	3rd Slide Trigger Guide Rod Screw Assy. (List # 18e-18f).	
18g	T 389P L	3rd Slide Waterkey Nipple with Plate.	
18h	T 390P L	Waterkey Saddle with Plate.	
18i	P 312	Waterkey Spring.	
18j	KOREK VK 5*11*8	Waterkey Nipple Cork.	
18k	KOREK 0.5*30*40	3rd Slide Waterkey Lever Cork.	
18l	S 063AP	Waterkey Screw, lacquer.	
18m	V 032 N	3rd Slide Waterkey Lever, nickel-plated.	
**	V 032 KPN	3rd Slide Waterkey Assy. complete (List # 18i-18m).	
19	THA 040 P2 Z1 L	3rd Slide Outer Tubing (1 of 2pcs).	
20	H 238P L	3rd Slide Outer Tubing Ring (1 of 2pcs).	
21	T 047 PP L	3rd Slide Trigger Stopper with Plate.	
22	S 254 N	3rd Slide Trigger Stopper Screw Nut (1 of 2pcs), nickel-plated.	
23	DK 003	3rd Slide Trigger Stopper Bumper.	
24	DK 001	3rd Slide Bumper (1 of 2pcs).	
25	A GX 0137A PP L	3rd Slide Brace with Plates.	
26	R 023 L	3rd Slide Crook, small.	
27	R 022 L	3rd Slide Crook, large.	
28	SKA 010 P2 Z2 L	3rd Slide Connecting Ferrule (1 of 2pcs).	
29	H 559 L	Connecting Ferrule (1st Valve Casing - to - 2nd Valve Casing).	
		Connecting Ferrule (2nd Valve Casing - to - 3rd Valve Casing).	
30	VENTIL 002 PK 1/2 L	1st/2nd Rotary Valve Assy.	
	VENTIL 002 PK 3 L	3rd Rotary Valve Assy.	
30a	S 355P	Bottom Cap, lacquer.	
30b	S 354 H	Rotary Valve Support.	
30c	VC 003MC H	Rotary Valve.	
30d	VCP 002MC PL	Rotary Valve Casing.	
30e	L 087P	Stop Plate, lacquer.	
30f	S 669P	Stop Plate Retaining Screw (1 pf 2pcs), lacquer.	
30g	SNURA 5	Bumper (length 1cm).	SNURA PR.5 = Bumper (length 1meter).
30h	T 268P	Stop Arm, lacquer.	
30i	S 434P	Stop Arm Retaining Screw, lacquer.	

**	MENIC 002MC PL	Rotary Valve with Casing, lapped (List # 30b-30d).	
**	SC 502FH PL	Valve Casing Assy. complete with Slides and Rotary Valves, (List # 12-30).	
31	P 112 K	Lever Bridge Assy., lacquer.	
31a	P 112 L	Lever Bridge.	
31b	S 660 L	Lever Bridge Post (1 of 4pcs).	
32	RA MC HOL 1/3	1st/3rd Valve Finger Lever Assy., lacquer.	
	RA MC HOL 2	2nd Valve Finger Lever Assy., lacquer.	
32a	N 053 L	Finger Lever Plate.	
32b	S 718 L	Finger Lever Rod.	
32c	N 032N 1/3 L	1st/3rd Valve Finger Lever Linkage.	
	N 032N 2 L	2nd Valve Finger Lever Linkage.	
33	S 717 H	Rod Screw.	
34	S 034P H	Rod Screw End Nut.	
35	S 021P H	Rod Screw Retaining Nut, small.	
36	S 022P H	Rod Screw Retaining Nut, large.	
**	TL 701CTR	Lever Assy., lacquer (List # 31-36).	
37	S 050P	Lever Bridge Retainung Screw (1 of 2pcs), lacquer.	
38	S 649P L	Lever Bridge Support (on 1st Slide).	
39	S 650P L	Lever Bridge Support (on 3rd Slide).	
40	P 093P L	Lever Bridge Support Plate (1 of 2pcs).	
41	PRUZ HOL MC	Lever Spring (1 of 3pcs).	
42	T 369	2nd/3rd Valve Linkage complete (type Standard), lacquer.	
	T 369B	1st Valve Linkage complete (type Standard), lacquer.	
42a	P 666P L	Linkage Rod.	
42b	S 636 L	Linkage Bearing (1 of 2pcs).	
43	S 281 H	Linkage Screw (1 of 2pcs).	
44	S 280 H	Linkage Screw Nut (1 of 2pcs).	
45	S 632 H	Ball Pivot (1 of 2pcs).	
46	T 404 L	1st Valve Linkage complete (type Minibal).	
	T 405 L	2nd/3rd Valve Linkage complete (type Minibal).	
46a	S 612 L	Linkage Rod.	
46b	MINIBAL GK6-3 L	Minibal (1 of 2pcs).	
47	S 121P L	Minibal Screw (1 of 2pcs).	
48	S 123P L	Minibal Screw Nut (Lever Side).	
49	MINIBAL DORAZ	Minibal Screw Bumper (Stop Arm side).	
50	T 370	3rd Slide Trigger Linkage Assy., lacquer.	
50a	P 667 L	3rd Slide Trigger Linkage Rod.	
50b	S 633 L	3rd Slide Trigger Linkage Bearing (1 of 2pcs).	
51	V 025 N	3rd Slide Trigger Lever, nickel-plated.	
52	P 383/CFH	3rd Slide Trigger Lever Spring.	
53	S 489 H	3rd Slide Trigger Lever Rod Screw.	
54	T 301P L	3rd Slide Trigger Lever Holder with Plate.	
55	SO 501FH PL	Mouthpipe Slide Assy.	
55a	THA 133 P2 Z1 L	Mouthpipe Slide Tube.	
55b	S 393P L	Mouthpipe Slide End Ring.	
55c	S 036P L	Mouthpipe Slide End Ring Barrel.	
56	U 501FH P	Mouthpipe Assy., lacquer.	
56a	THE 135 P2 L	Mouthpipe Tube.	
56b	S 392P L	Mouthpipe End Ring.	
56c	S 004PR L	Mouthpipe End Ring Knob (1 of 2pcs).	
56d	U 133 H	Mouthpipe Insert, upper.	
56e	H 508 H	Mouthpipe Insert, lower.	
57	T 280 N	Mouthpipe Retaining Screw, nickel-plated.	
58	F 004A L	Finger Support.	
59	T 033P L	Cardholder Socket with Plate.	
60	S 040P	Cardholder Screw, lacquer.	
61	T 226P L	Rod Brace with Plate.	
62	T 225P L	Barrel with Plate.	
63	A LY 0100A PP72 L	Brace with Plates, Mouthpipe Slide End Ring - to - Bell.	<i>Brace Length to be specified.</i>
64	A LX 0280A PP L	Brace with Plates, Mouthpipe Slide - to - Bell.	<i>Brace Length to be specified.</i>
65	A LX 0030B PP L	Brace with Plates, Branch - to - Bell.	<i>Brace Length to be specified.</i>
66	A LX 0190A PP L	Brace with Plates, Branch - to - 3rd Slide.	<i>Brace Length to be specified.</i>

**Important:**

1/ All metal parts polished and unlacquered, unless otherwise specified. Please specify desired finish, when ordering.

2/ Please indicate the Instrument's Model Number, when ordering.