

## Rotary Valve Instruments



Fluegelhorns

### **Bb Fluegelhorn CFH 501P**

*Pictured CFH 501R*



### **V.F.Cervený Bb Fluegelhorn CFH 501P**

***3 valves, yellow brass, bore 11.1mm, bell 145mm, waterkey, nickel-silver Mouthpipe, Valve Casings & Trimmings, lacquer, silver-plated Fluegelhorn-mouthpiece # 1 1/2F, plastic case # 6720.***

#### ***Available Options:***

***X - Minibal Linkage Action.***

***R - Bell Rim***

***T - 3rd Slide Trigger.***

***Last Update February2005***

# CFH 501P

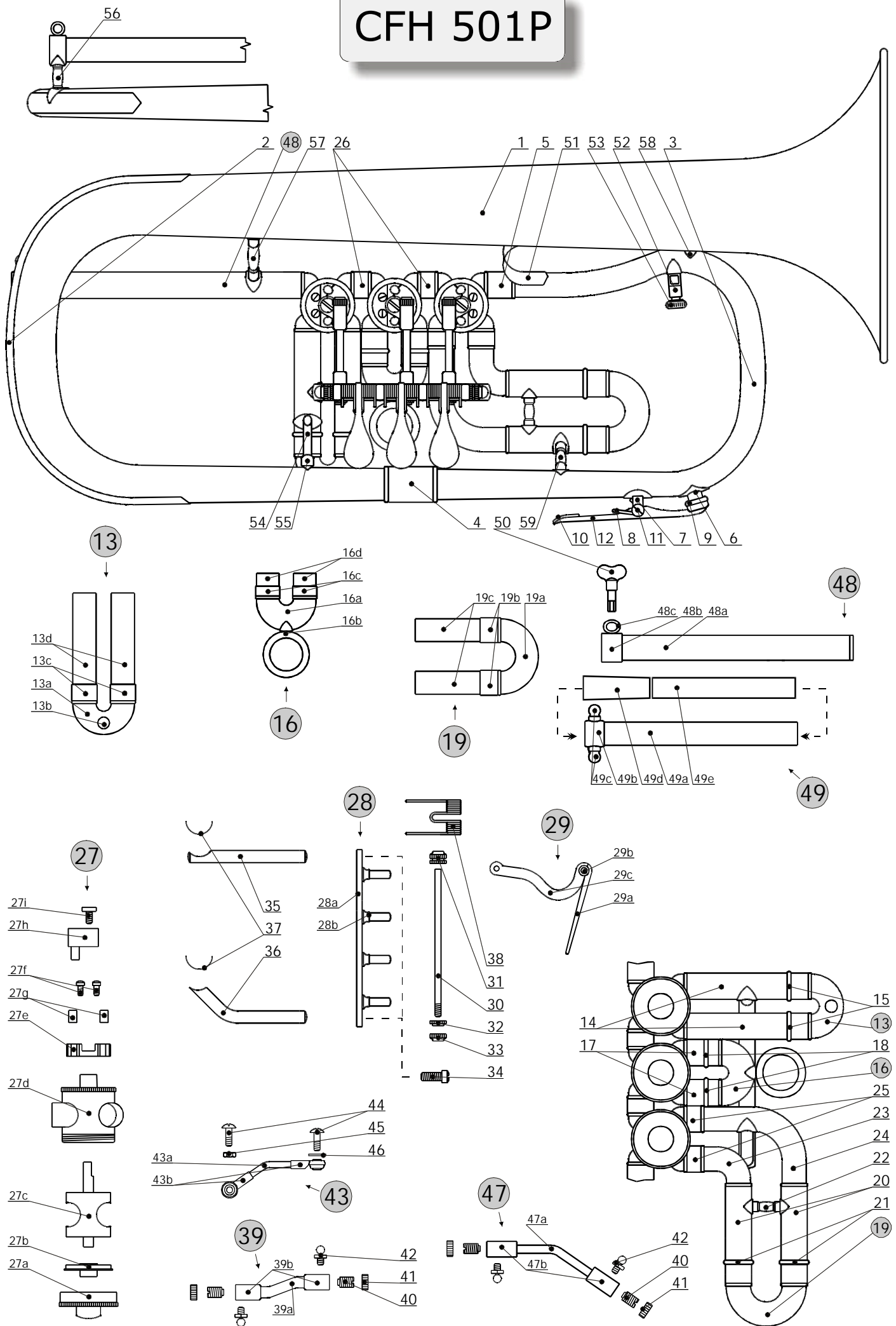

## Parts For V.F.Cerveny Bb Rotary Valve Fluegelhorn CFH 501P.

List #	Part #	Description	Note
1	OZV 501FH KL	Bell with Guard, engraved with the 'V.F.Cerveny' Logo.	For CFH 501 Models.
	OZV 501FH KRL	Bell with Rim and Guard, engraved with the 'V.F.Cerveny' Logo.	For CFH 501R Models.
2	DH 098 L	Bell Guard.	
3	DH 021 L	Branch.	
4	S 159P Z2 L	Connecting Ferrule, Bell - to - Branch.	
5	H 556P L	Connecting Ferrule, Branch - to - 3rd Valve Casing.	
6	T 347P L	Branch Waterkey Nipple with Plate.	Outer Tubing to be ordered separately.
7	T 351P L	Waterkey Saddle with Plate.	
8	P 312	Waterkey Spring.	
9	KOREK VK 5*11*8	Waterkey Nipple Cork.	
10	KOREK 0.5*30*40	Waterkey Lever Cork.	
11	S 063AP	Waterkey Screw, lacquer.	
12	V 030 N	Branch Waterkey Lever, nickel-plated.	
**	V 030 KPN	Branch Waterkey Assy. complete (List # 8-12).	
13	SN 501TR 1PK	1st Slide complete, lacquer.	Outer Tubing to be ordered separately.
13a	O 004 L	1st Slide Bow.	
13b	S 004P L	1st Slide Bow Knob.	
13c	HTA 010 P2 Z1 L	1st Slide Ferrule (1 of 2pcs).	
13d	THE 053 P2 L	1st Slide Inner Tubing (1 of 2pcs).	
14	THA 053 P2 Z1 L	1st Slide Outer Tubing (1 of 2pcs).	
15	H 238P L	1st Slide Outer Tubing Ring (1 of 2pcs).	
16	SN 501TR 2PK	2nd Slide complete, lacquer.	Outer Tubing to be ordered separately.
16a	O 004 L	2nd Slide Bow.	
16b	H 056 L	2nd Slide Finger Ring with Plate.	
16c	HTA 006.5 P2 Z1 L	2nd Slide Ferrule (1 of 2pcs).	
16d	THE 010.5 P2 L	2nd Slide Inner Tubing (1 of 2pcs).	
17	THA 012 P2 Z1 L	2nd Slide Outer Tubing (1 of 2pcs).	
18	H 238P L	2nd Slide Outer Tubing Ring (1 of 2pcs).	
19	SN 501TR 3PK	3rd Slide complete, lacquer.	Outer Tubing to be ordered separately.
19a	O 061 L	3rd Slide Bow.	
19b	HTA 010 P2 Z1 L	3rd Slide Ferrule (1 of 2pcs).	
19c	THE 039 P2 L	3rd Slide Inner Tubing (1 of 2pcs).	
20	THA 040 P2 Z1 L	3rd Slide Outer Tubing (1 of 2pcs).	
21	H 238P L	3rd Slide Outer Tubing Ring (1 of 2pcs).	
22	A GX 0137A PP L	3rd Slide Brace with Plates.	
23	R 023 L	3rd Slide Crook, small.	
24	R 022 L	3rd Slide Crook, large.	
25	SKA 010 P2 Z2 L	3rd Slide Connecting Ferrule (1 of 2pcs).	
26	H 559 L	Connecting Ferrule (1st Valve Casing - to - 2nd Valve Casing). Connecting Ferrule (2nd Valve Casing - to - 3rd Valve Casing).	
27	VENTIL 002 PK 1/2 L	1st/2nd Rotary Valve Assy.	
	VENTIL 002 PK 3 L	3rd Rotary Valve Assy.	
27a	S 355P	Bottom Cap, lacquer.	
27b	S 354 H	Rotary Valve Support.	
27c	VC 003MC H	Rotary Valve.	
27d	VCP 002MC PL	Rotary Valve Casing.	
27e	L 087P	Stop Plate, lacquer.	
27f	S 669P	Stop Plate Retaining Screw (1 pf 2pcs), lacquer.	
27g	SNURA 5	Bumper (length 1cm).	SNURA PR.5 = Bumper (length 1meter).
27h	T 268P	Stop Arm, lacquer.	
27i	S 434P	Stop Arm Retaining Screw, lacquer.	
**	MENIC 002MC PL	Rotary Valve with Casing, lapped (List # 27b-27d).	
**	SC 501TR PL	Valve Casing Assy. complete with Slides and Rotary Valves, (List # 13-27).	
28	P 112 K	Lever Bridge Assy., lacquer.	
28a	P 112 L	Lever Bridge.	
28b	S 660 L	Lever Bridge Post (1 of 4pcs).	
29	RA MC HOL 1/3	1st/3rd Valve Finger Lever Assy., lacquer.	
	RA MC HOL 2	2nd Valve Finger Lever Assy., lacquer.	
29a	N 053 L	Finger Lever Plate.	
29b	S 718 L	Finger Lever Rod.	
29c	N 032N 1/3 L	1st/3rd Valve Finger Lever Linkage.	
	N 032N 2 L	2nd Valve Finger Lever Linkage.	
30	S 717 H	Rod Screw.	
31	S 034P H	Rod Screw End Nut.	
32	S 021P H	Rod Screw Retaining Nut, small.	

33	S 022P H	Rod Screw Retaining Nut, large.	
**	TL 701CTR	Lever Assy., lacquer (List # 28-33).	
34	S 050P	Lever Bridge Retaining Screw (1 of 2pcs), lacquer.	
35	S 649P L	Lever Bridge Support (on 1st Slide).	
36	S 650P L	Lever Bridge Support (on 3rd Slide).	
37	P 093P L	Lever Bridge Support Plate (1 of 2pcs).	
38	PRUZ HOL MC	Lever Spring (1 of 3pcs).	
39	T 343P	2nd/3rd Valve Linkage complete (type Standard), lacquer.	<i>Older style Linkage.</i>
	T 342P	1st Valve Linkage complete (type Standard), lacquer.	<i>Older style Linkage.</i>
39a	P 643P L	Linkage Rod.	
39b	S 636 L	Linkage Bearing (1 of 2pcs).	
40	S 281 H	Linkage Screw (1 of 2pcs).	
41	S 280 H	Linkage Screw Nut (1 of 2pcs).	
42	S 632 H	Ball Pivot (1 of 2pcs).	
43	T 404 L	1st Valve Linkage complete (type Minibal).	
	T 405 L	2nd/3rd Valve Linkage complete (type Minibal).	
43a	S 612 L	Linkage Rod.	
43b	MINIBAL GK6-3 L	Minibal (1 of 2pcs).	
44	S 121P L	Minibal Screw (1 of 2pcs).	
45	S 123P L	Minibal Screw Nut (Lever Side).	
46	MINIBAL DORAZ	Minibal Screw Bumper (Stop Arm side).	
47	T 369	2nd/3rd Valve Linkage complete (type Standard), lacquer.	<i>Newer style Linkage.</i>
	T 369B	1st Valve Linkage complete (type Standard), lacquer.	<i>Newer style Linkage.</i>
47a	P 666P L	Linkage Rod.	
47b	S 636 L	Linkage Bearing (1 of 2pcs).	
48	SO 501FH PL	Mouthpipe Slide Assy.	
48a	THA 133 P2 Z1 L	Mouthpipe Slide Tube.	
48b	S 393P L	Mouthpipe Slide End Ring.	
48c	S 036P L	Mouthpipe Slide End Ring Barrel.	
49	U 501FH P	Mouthpipe Assy., lacquer.	
49a	THE 135 P2 L	Mouthpipe Tube.	
49b	S 392P L	Mouthpipe End Ring.	
49c	S 004PR L	Mouthpipe End Ring Knob (1 of 2pcs).	
49d	U 133 H	Mouthpipe Insert, upper.	
49e	H 508 H	Mouthpipe Insert, lower.	
50	T 280 N	Mouthpipe Retaining Screw, nickel-plated.	
51	F 004A L	Finger Support.	
52	T 033P L	Cardholder Socket with Plate.	
53	S 040P	Cardholder Screw, lacquer.	
54	T 226P L	Rod Brace with Plate.	
55	T 225P L	Barrel with Plate.	
56	A LY 0090A PP72 L	Brace with Plates, Mouthpipe Slide End Ring - to - Bell.	<i>Brace Length to be specified.</i>
57	A LX 0280A PP L	Brace with Plates, Mouthpipe Slide - to - Bell.	<i>Brace Length to be specified.</i>
58	A LX 0030B PP L	Brace with Plates, Branch - to - Bell.	<i>Brace Length to be specified.</i>
59	A LX 0170A PP L	Brace with Plates, Branch - to - 3rd Slide.	<i>Brace Length to be specified.</i>

**Important:**

1/ All metal parts polished and unlacquered, unless otherwise specified. Please specify desired finish, when ordering.

2/ Please indicate the Instrument's Model Number, when ordering.