

INSTRUMENTS PARTS CATALOGUE

Piston Valve Instruments

Trumpets



C/Bb Trumpet ATR 242I



AMATI C/Bb Trumpet ATR 242I

***3 valves, bore 11.7mm, bell 125mm, 2 waterkeys,
3rd slide adjustable tuning finger ring, lacquer,
silver-plated mouthpiece # 7C,
Plastic case # 6712.***

Last Update February 2005

www.amati-denak.cz

ATR 242I

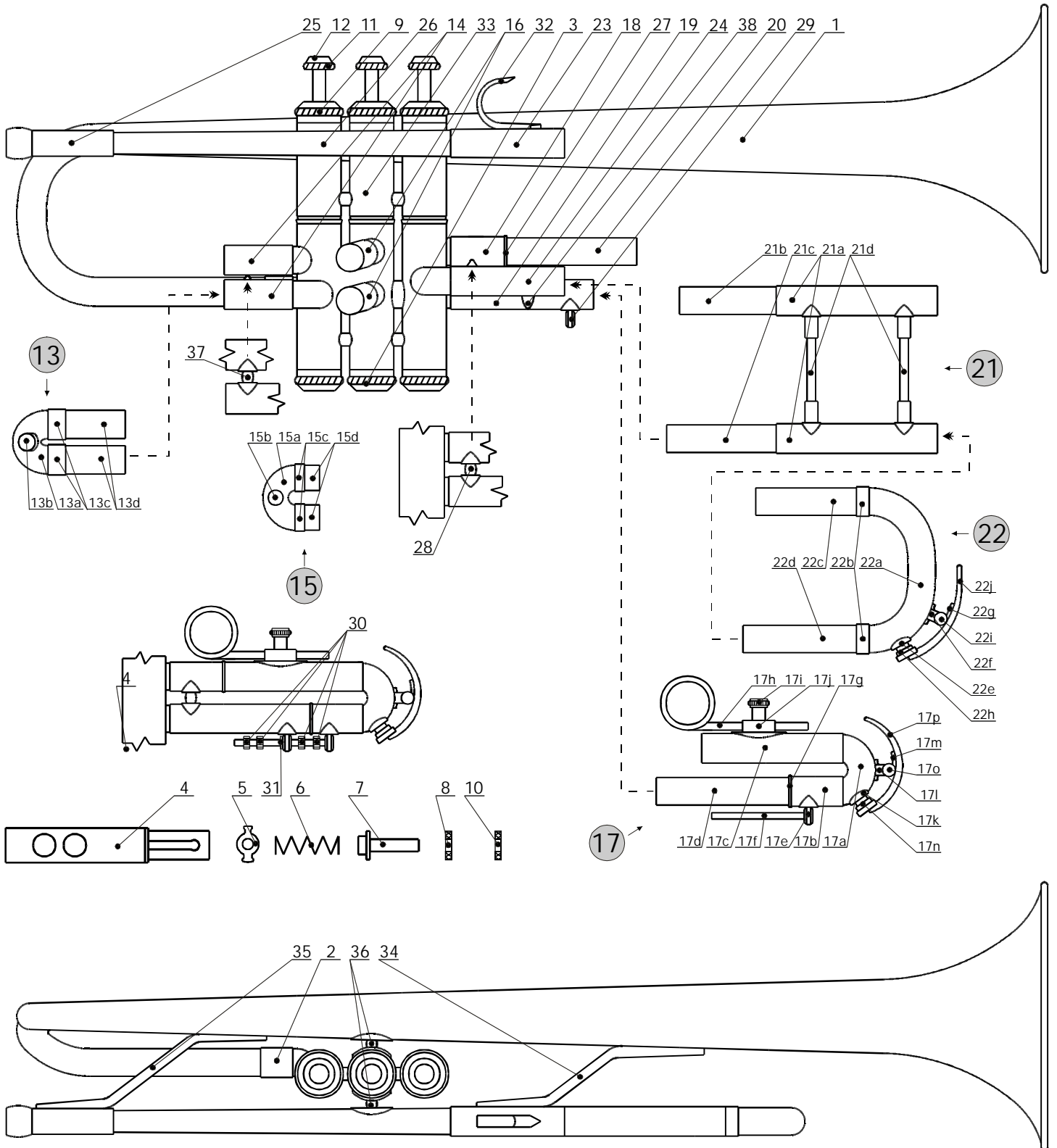

Parts For AMATI C/Bb Trumpet ATR 242I.

List #	Part #	Description	Note
1	OZV 211TR L	Bell, engraved with the 'Amati Kraslice' Logo.	
2	H 013 L	Connecting Ring, Bell - to - 1st Valve Casing.	
3	X 123	Bottom Cap, lacquer.	
	M 131TR 1	1st Valve.	
4	M 131TR 2	2nd Valve.	
	M 131TR 3	3rd Valve.	
5	Z 0040	Valve Guide.	
6	P 310	Valve Spring.	
7	S 153 H	Valve Stem Plug.	
8	G 004BE	Valve Stem Plug Felt, Blue.	
9	X 122	Top Cap, lacquer.	
10	G 007BR	Top Cap Felt, Brown.	Also available: G 007RE (red), G 007B (black), G 007GN (green), G 007BE (blue).
11	X 121 K	Finger Button complete with Pearl, lacquer.	
12	PERLET 13	Pearl Inlay.	
13	SN 242TR 1K	1st Slide complete, lacquer.	<i>Outer Tubing to be ordered separately.</i>
13a	O 006 L	1st Slide Bow.	
13b	S 497 L	1st Slide Bow Knob.	
13c	HTA 006 MU3 L	1st Slide Ferrule (1 of 2pcs).	
13d	THE 032 MU3 L	1st Slide Inner Tubing (1 of 2pcs).	
14	THA 034 MU3 L	1st Slide Outer Tubing (1 of 2pcs).	
15	SN 242TR 2K	2nd Slide complete, lacquer.	<i>Outer Tubing to be ordered separately.</i>
15a	O 006 L	2nd Slide Bow.	
15b	S 497 L	2nd Slide Bow Knob.	
15c	HTA 004 MU3 L	2nd Slide Ferrule (1 of 2pcs).	
15d	THE 009.5 MU3 L	2nd Slide Inner Tubing (1 of 2pcs).	
16	THA 011 MU3 L	2nd Slide Outer Tubing (1 of 2pcs).	
17	SN 242TR 3K	3rd Slide complete, lacquer.	
17a	O 006 L	3rd Slide Bow.	
17b	HTA 024 MU3 DL	3rd Slide Ferrule (lower).	
17c	THA 069 MU3 HL	3rd Slide Outer Tubing (upper).	
17d	THE 085 MU3 L	3rd Slide Inner Tubing.	
17e	TU 047 L	3rd Slide Guide Rod Screw Holder with Plate.	
17f	S 253 H	3rd Slide Guide Rod Screw.	
**	TU 048A L	3rd Slide Guide Rod Screw Assy. (List # 17e-17f).	
17g	DK 001	3rd Slide Bumper (1 of 2pcs).	
17h	T 041	3rd Slide Tuning Finger Ring complete with Rod, lacquer.	
17i	S 040	Cardholder Screw, lacquer.	
17j	T 028 L	Cardholder Socket with Plate.	
17k	S 499 L	3rd Slide Waterkey Nipple.	
17l	P 373 L	3rd Slide Waterkey Saddle.	
17m	P 312	Waterkey Spring.	
17n	KOREK VK 4*8.5	Waterkey Cork.	
17o	S 063	Waterkey Screw, lacquer.	
17p	VKM 044	3rd Slide Waterkey Lever, lacquer.	
**	VKM 044 K	3d Slide Waterkey Assy. complete (List # 17m-17p), lacquer.	
18	HTA 024 MU3 HL	3rd Slide Ferrule (upper).	
19	THA 069 MU3 DL	3rd Slide Outer Tubing (lower).	
20	THE 101 MU3 L	3rd Slide Inner Tubing.	
21	LS 242TR BK	Bb Tuning Slide complete, lacquer.	<i>Outer Tubing to be ordered separately.</i>
21a	THA 075 MU3 L	Bb Tuning Slide Outer Tubing (1of 2pcs).	
21b	THE 044 MU3 L	Bb Tuning Slide Inner Tubing, short (upper).	
21c	THE 051 MU3 L	Bb Tuning Slide Inner Tubing, long (lower).	
21d	A 400 L	Bb Tuning Slide Brace with Plates (1 of 2pcs).	
22	LS 242TR K	C Tuning Slide complete, lacquer.	
22a	O 093AK L	Tuning Slide Bow.	
22b	HTA 006 MU3 L	Tuning Slide Ferrule (1 of 2pcs).	
22c	THE 047 MU3 L	Tuning Slide Inner Tubing, short (upper).	
22d	THE 053 MU3 L	Tuning Slide Inner Tubing, long (lower).	
22e	S 498 L	Tuning Slide Waterkey Nipple.	
22f	P 372 L	Tuning Slide Waterkey Saddle.	
22g	P 312	Waterkey Spring.	
22h	KOREK VK 4*8.5	Waterkey Cork.	
22i	S 063	Waterkey Screw, lacquer.	

22j	VKM 043	Tuning Slide Waterkey Lever, lacquer.	
**	VKM 043 K	Tuning Slide Waterkey Assy. compl. (List # 22g-22j), lacquer.	
23	THA 056 MU3 HL	Tuning Slide Outer Tubing (upper).	
24	THA 056 MU3 DL	Tuning Slide Outer Tubing (lower).	
25	U 242TR L	Mouthpiece Receiver, engraved with Model Number.	
26	D 078 L	Mouthpipe.	
	ESO 242TR L	Mouthpipe complete with Mouthpiece Receiver.	
27	DK 001	3rd Slide Bumper (1 of 2pcs).	
28	A UX 0045B MM L	3rd Slide Brace with Plates.	
29	TU 047 L	3rd Slide Stopper with Plate.	
30	S 254 H	3rd Slide Stopper Screw Nut (1 of 4pcs).	
31	DK 003	3rd Slide Stopper Bumper.	
32	F 013 L	Mouthpipe Right Hand Pinky Hook.	
33	PS 213TR L	Valve Casing Assy. without Slides.	<i>Valves to be ordered separately.</i>
	SP 242TR L	Valve Casing Assy. complete with Slides.	<i>Valves to be ordered separately.</i>
34	A 233 L	Bell - to - Tuning Slide Brace.	<i>Brace Length to be specified.</i>
35	A 234 L	Bell - to - Mouthpiece Receiver Brace.	<i>Brace Length to be specified.</i>
36	A DB 0035B MM L	Brace with Plates, Mouthpipe - to - 2nd Valve Casing.	<i>Brace Length to be specified.</i>
		Brace with Plates, Bell - to - 2nd Valve Casing.	<i>Brace Length to be specified.</i>
37	A UX 0076B MM L	Brace with Plates, Bell - to - 1st Slide.	<i>Brace Length to be specified.</i>
38	A UX 0095B MM L	Brace with Plates, Tuning Slide - to - 3rd Slide (Stopper Brace).	<i>Brace Length to be specified.</i>

Important:

1/ All metal parts polished and unlacquered, unless otherwise specified. Please specify desired finish, when ordering.

2/ Please indicate the Instrument's Model Number, when ordering.