

## Brass Instruments

### Slide Trombones



#### **Bb Slide Trombone ASL 612**



#### ***AMATI Bb Slide Trombone ASL 612***

***professional model, lightweight nickel-silver inner and outer hand slide, inner hand slide chrome-plated, bore 12.7mm, bell 200mm, balance weight, waterkey, nickel-silver trimmings, ergonomic hand braces, lacquer, silver-plated mouthpiece # 11C, plastic case # 6660.***

***Last Update March2004***

# ASL 612

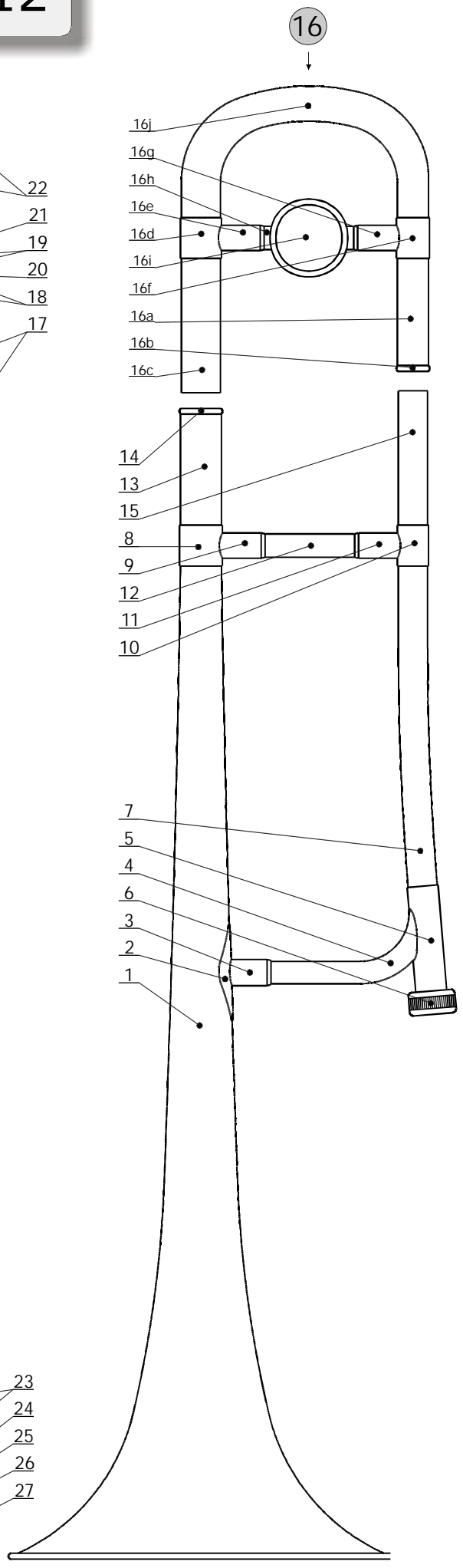
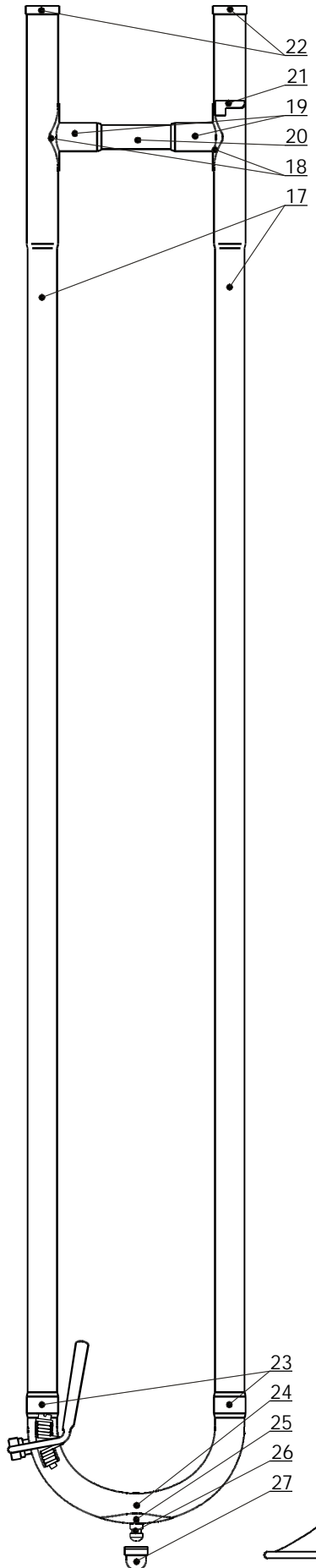
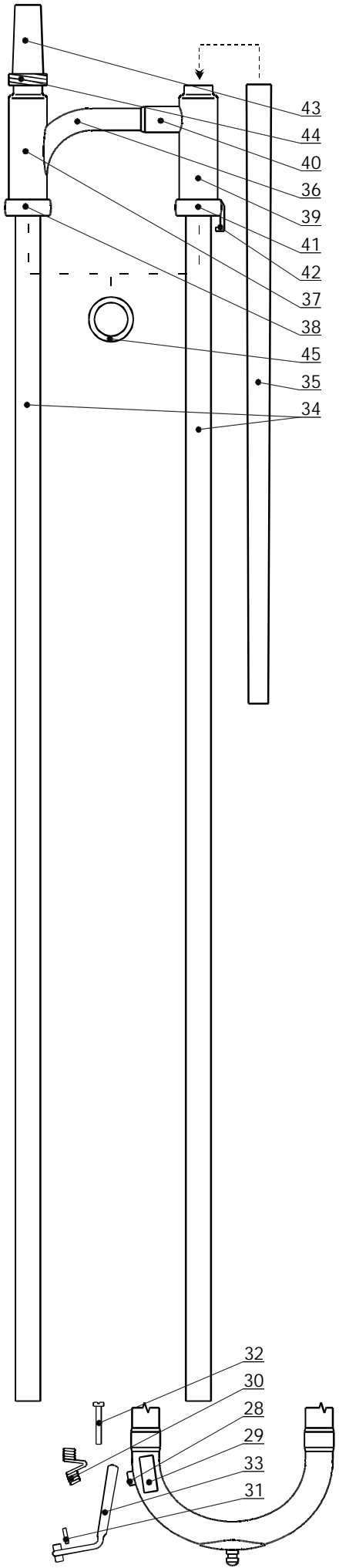

## Parts For AMATI Bb Slide Trombone ASL 612.

List #	Part #	Description	Note
<i>Bell Section</i>			
1	OZV 312SL L	Bell, engraved with the 'Amati Kraslice' Logo.	
2	P 003P L	Plate.	
3	H 142P L	Brace Socket.	
**	T 015 L	Brace Socket complete with Plate (List # 2-3).	
4	P 081P L	Brace Tube.	
5	S 157P L	Slide Receiver.	
6	S 200 L	Bell Lock Nut.	
**	T 019 L	Slide Receiver Assy. (List # 4-6).	
7	DH 225 L	Gooseneck.	
8	H 135 L	Connecting Ring large, Tuning Slide - to - Bell.	
9	H 151 L	Brace Socket for large Ring.	
**	T 151 L	Brace Socket complete with Ring (List # 8-9).	
10	H 138 L	Connecting Ring small, Tuning Slide - to - Goosneck.	
11	H 152 L	Brace Socket for small Ring.	
**	T 152 L	Brace Socket complete with Ring (List # 10-11).	
12	H 122 L	Brace Tube.	
13	THA 070 P11 L	Tuning Slide Outer Tubing, large.	
14	S 198P L	Tuning Slide Outer Tubing Ring, large.	
15	THE 080 P6 L	Tuning Slide Inner Tubing, small.	
16	LS 612SL K	Tuning Slide complete, lacquer.	
16a	THA 070 P6 L	Tuning Slide Outer Tubing, small.	
16b	S 197P L	Tuning Slide Outer Tubing Ring, small.	
16c	THE 080 P11 L	Tuning Slide Inner Tubing, large.	
16d	H 136 L	Connecting Ring large, Tuning Slide Tubing - to - Crook.	
16e	H 150 L	Brace Socket for large Ring.	
**	T 150 L	Brace Socket complete with Ring (List # 16d-16e).	
16f	H 327 L	Connecting Ring small, Tuning Slide Tubing - to - Crook.	
16g	H 153 L	Brace Socket for small Ring.	
**	T 153 L	Brace Socket complete with Ring (List # 16f-16g).	
16h	H 122 L	Brace Tube.	
16i	S 179M L	Balance Weight.	
16j	OH 11 L	Tuning Slide Crook.	
**	OZV 612SL K	Bell Assy. complete (List # 1-16), lacquer.	
<i>Hand Slide Section</i>			
17	MS 002Y L	Hand Slide Outer Tubing (1 of 2pcs).	
18	P 004P L	Plate (1 of 2pcs).	
19	H 140P L	Brace Socket (1 of 2pcs).	
**	T 016 L	Brace Socket complete with Plate (List # 18-19).	
20	H 143P L	Brace Tube.	
21	P 276 L	Slide Lock Nut Hinge.	
22	H 047P L	Outer Slide End Ferrule.	
23	H 046P L	Hand Slide Ferrule (1 of 2pcs).	
24	O 127 L	Hand Slide Crook.	
25	P 609P L	Hand Slide Crook Guard Plate.	
26	S 047P L	Hand Slide Crook Guard.	
**	T 017 L	Hand Slide Crook Guard complete with Plate (List # 25-26).	
27	CEPICKA SL	Hand Slide Crook Guard Bumper.	
28	S 499 L	Waterkey Nipple.	
29	P 289 L	Waterkey Saddle.	
30	P VKP	Waterkey Spring.	
31	KOREK VK 5*11*8	Waterkey Cork.	
32	S 069P	Waterkey Screw, lacquer.	
33	VKV 034 N	Waterkey Lever, nickel-plated.	
**	VKV 034 KN	Waterkey Assy. complete (List # 30-33).	
**	SN 612SL O	Outer Hand Slide Assy. complete (List # 17-33), lacquer.	
34	MI 002Y CR	Hand Slide Inner Tubing (1 of 2pcs), chrome-plated.	
35	DH 499A L	Mouthpipe.	
36	P 082P L	Brace Tube.	
37	S 359 L	Slide Overpart.	
**	T 018 L	Slide Overpart complete with Brace Tube (List # 36-37).	
38	S 361 L	Slide Overpart Nut.	
39	S 358 L	Mouthpiece Receiver.	
40	H 141P L	Brace Socket.	

41	S 360 L	Slide Lock Nut.
42	S 350 L	Slide Lock Nut Tab.
**	T 021	Slide Lock Nut complete, lacquer (List # 41-42).
**	T 020 L	Mouthpiece Receiver Assy. (List # 39-42).
43	S 180P L	End Shank.
44	S 181 L	End Shank Thread.
45	DK MI 001	Slide Bumper (1 of 2pcs).
**	SN 612SL I	Inner Hand Slide Assy. complete (List # 34-45), lacquer.
**	SN 612SL K	Hand Slide Assy., complete (List # 17-45), lacquer.

**Important:**

1/ All metal parts polished and unlacquered, unless otherwise specified. Please specify desired finish, when ordering.

2/ Please indicate the Instrument's Model Number, when ordering.