

Mouthpipe For Amati Sousaphone

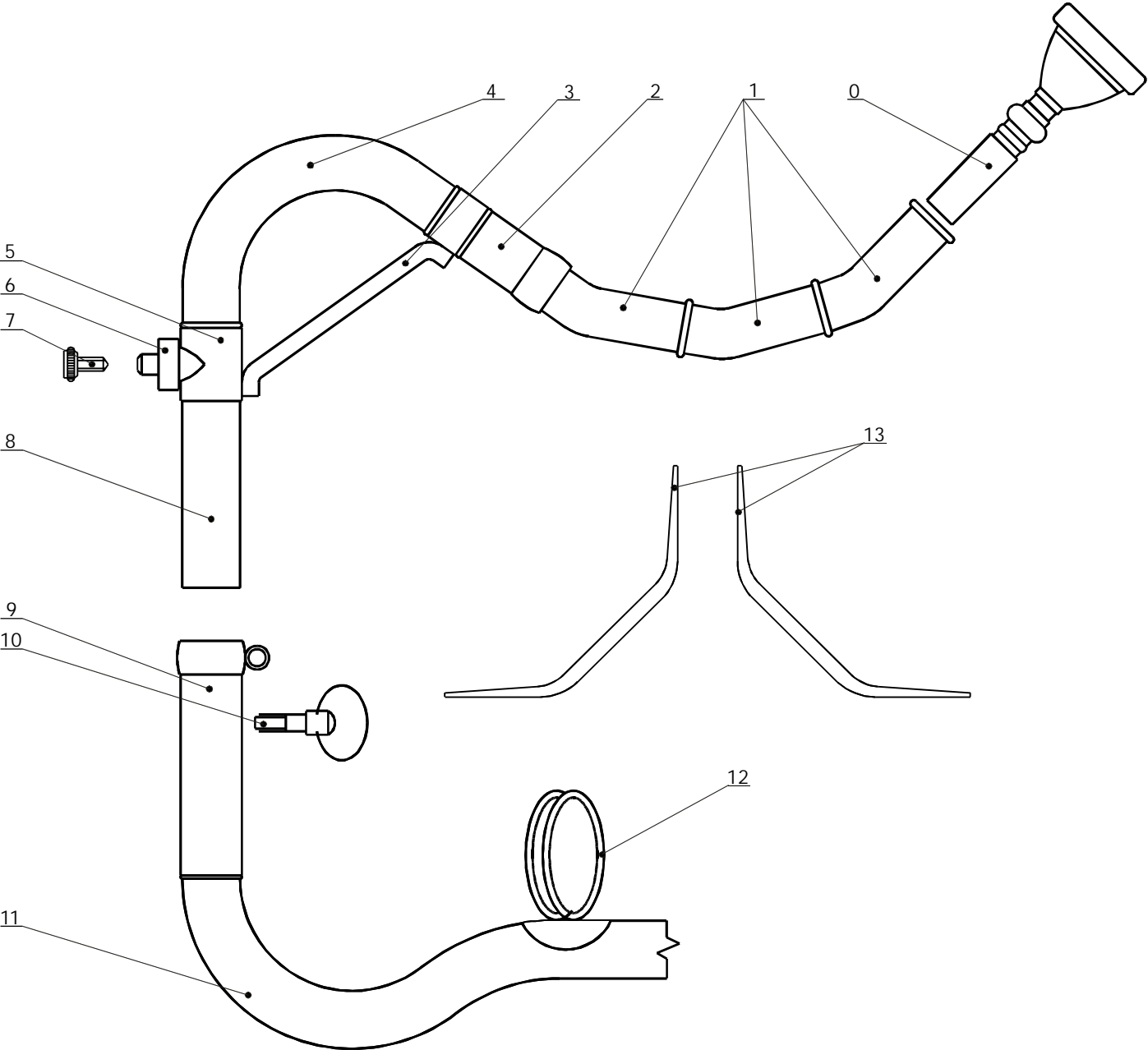

Parts For AMATI Sousaphone Mouthpipe
AMATI F Sousaphone ASH 252 and AMATI Eb Sousaphone ASH 254.

<i>List #</i>	<i>Part #</i>	<i>Description</i>	<i>Note</i>
	ESO 254SH	Upper Mouthpipe, complete (List # 2-8), lacquer.	
	ESO 254SH A	Lower Mouthpipe, complete (List # 9-12), lacquer.	
0	25	Mouthpiece, silver-plated	
1	DH 130A	Tuning Bit, lacquer (1 piece).	
	DH 130A SADA	Tuning Bits, lacquer (Set of 3 pieces).	
2	U 260SH L	Connecting Cone (Bit Receiver).	
3	P 388 L	Mouthpipe Brace.	
4	DH 129 L	Mouthpipe Bow.	
5	H 343 L	Connecting Ferrule.	
6	T 341 L	Cardholder Socket with Plate.	
7	S 040	Cardholder Socket Screw, lacquer.	
8	H 356 L	Inner Slide.	
9	SO 254SH L	Mouthpipe Connection, engraved with Model Number.	
10	T 281	Mouthpipe Connection Screw, lacquer.	
11	DH 154 L	Lower Mouthpipe.	
12	S 019 L	Thumb Ring with Plate.	
13	P 390M/398 L	Lower Mouthpipe Braces (Set of 2 Braces).	<i>Braces not bent, customer's adjustment required for each instrument</i>

Important:

- 1/ All metal parts polished and unlacquer, unless otherwise specified. Please specify desired finish, when ordering.*
- 2/ Please indicate the Instrument's Model Number, when ordering.*

Parts For AMATI Sousaphone Mouthpipe
AMATI Bb Sousaphone ASH 260.

<i>List #</i>	<i>Part #</i>	<i>Description</i>	<i>Note</i>
	ESO 260SH	Upper Mouthpipe, complete (List # 2-8), lacquer.	
	ESO 260SH A	Lower Mouthpipe, complete (List # 9-12), lacquer.	
0	24AW	Mouthpiece, silver-plated	
1	DH 130A	Tuning Bit, lacquer (1 piece).	
	DH 130A SADA	Tuning Bits, lacquer (Set of 3 pieces).	
2	U 260SH L	Connecting Cone (Bit Receiver).	
3	P 388 L	Mouthpipe Brace.	
4	DH 129 L	Mouthpipe Bow.	
5	H 340M L	Connecting Ferrule.	
6	T 341 L	Cardholder Socket with Plate.	
7	S 040	Cardholder Socket Screw, lacquer.	
8	H 341 L	Inner Slide.	
9	SO 260SH L	Mouthpipe Connection, engraved with Model Number.	
10	T 281	Mouthpipe Connection Screw, lacquer.	
11	DH 155 L	Lower Mouthpipe.	
12	S 019 L	Thumb Ring with Plate.	
13	P 398 I	Lower Mouthpipe Braces (Set of 2 Braces).	<i>Braces not bent, customer's adjustment required for each instrument</i>

Important:

- 1/ All metal parts polished and unlacquer, unless otherwise specified. Please specify desired finish, when ordering.
- 2/ Please indicate the Instrument's Model Number, when ordering.

Parts For AMATI Sousaphone Mouthpipe
AMATI C/Bb Sousaphone ASH 262A.

<i>List #</i>	<i>Part #</i>	<i>Description</i>	<i>Note</i>
	ESO 260SH	Upper Mouthpipe, complete (List # 2-8), lacquer	
	ESO 260SH A	Lower Mouthpipe, complete (List # 9-12), lacquer	
0	24AW	Mouthpiece, silver-plated	
1	DH 130A	Tuning Bit, lacquer (1 piece).	
	DH 130A SADA	Tuning Bits, lacquer (Set of 3 pieces).	
2	U 260SH L	Connecting Cone (Bit Receiver)	
3	P 388 L	Mouthpipe Brace.	
4	DH 129 L	Mouthpipe Bow.	
5	H 340M L	Connecting Ferrule.	
6	T 341 L	Cardholder Socket with Plate.	
7	S 040	Cardholder Socket Screw, lacquer.	
8	H 341 L	Inner Slide.	
9	SO 260SH L	Mouthpipe Connection, engraved with Model Number.	
10	T 281	Mouthpipe Connection Screw, lacquer.	
11	DH 155 L	Lower Mouthpipe.	
12	S 019 L	Thumb Ring with Plate.	
13	P 398 L	Lower Mouthpipe Braces (Set of 2 Braces).	<i>Braces not bent, customer's adjustment required for each instrument</i>

Important:

1/ All metal parts polished and unlacquer, unless otherwise specified. Please specify desired finish, when ordering.

2/ Please indicate the Instrument's Model Number, when ordering.