

Piston Valve Instruments

Alto Horns



Eb Alto Horn AAH 611



AMATI Eb Alto Horn AAH 611

professional upright model, 3 top action valves, bore 11.7mm, bell 200mm, nickel-silver trimmings, tuning slide water key, lacquer, silver-plated mouthpiece # 5, plastic case # 6631.

Last Update February 2004

AAH 611

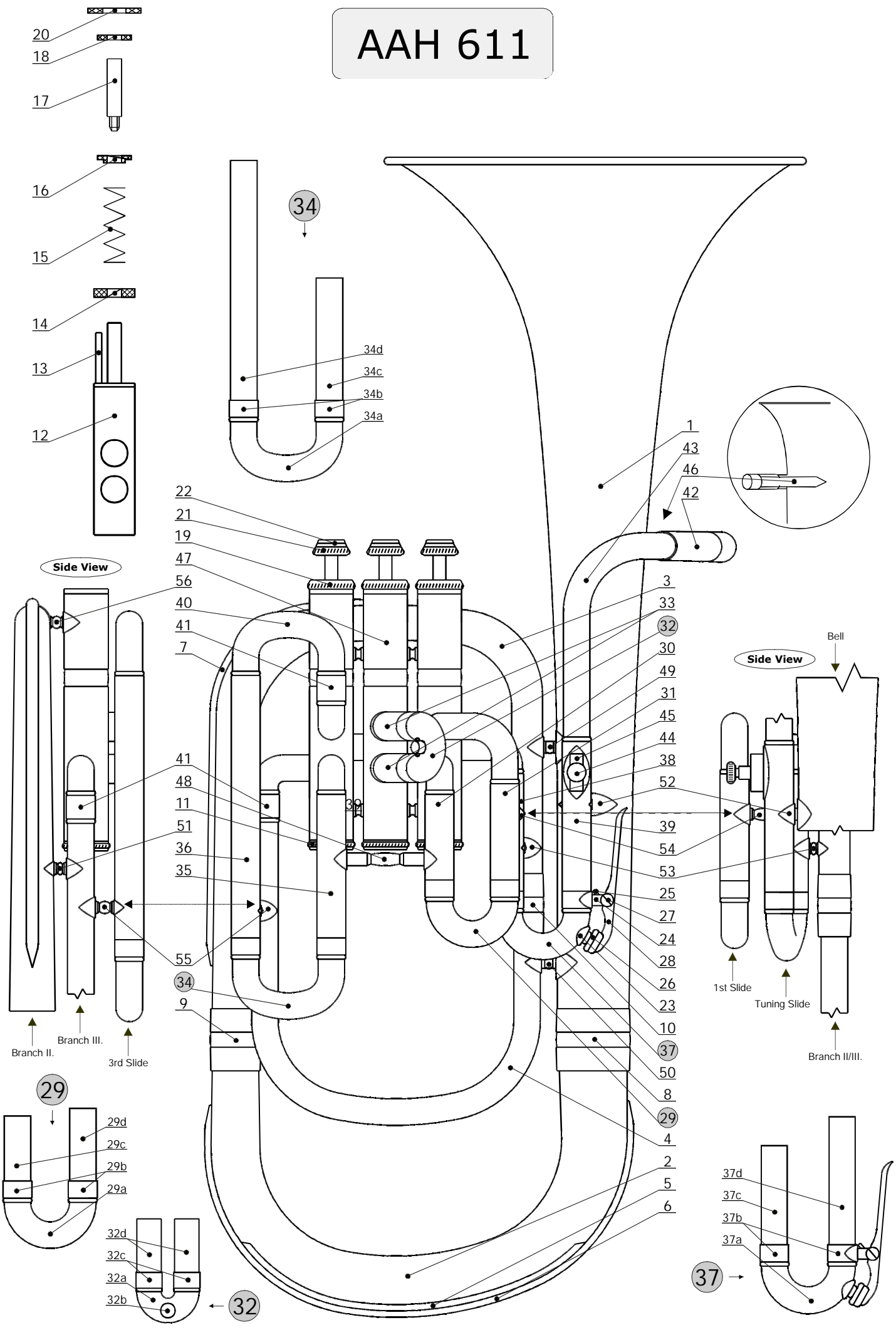

Parts For AMATI Eb Alto Horn AAH 611.

List #	Part #	Description	Note
1	OZV 211AH L	Bell, engraved with the 'Amati Kraslice' Logo.	
2	DH 004 L	Branch I (Bottom Bend).	
	DH 004 KL	Branch I complete with Bottom Bend Guard and Comb.	
3	DH 160 L	Branch II.	
	DH 160 KL	Branch II complete with Comb.	
4	DH 161 L	Branch III.	
5	DH 056 L	Bottom Bend Guard.	
6	ST 316/DH 004 L	Bottom Bend Guard Comb.	
7	ST 316/DH 160 L	Branch II Comb.	
8	S 708 L	Connecting Ferrule, Bell - to - Branch I.	
9	S 709 L	Connecting Ferrule, Branch I - to - Branch II.	
10	S 710 L	Connecting Ferrule, Branch II - to - Branch III.	
11	X 123 N	Bottom Cap, nickel-plated.	
12	M 611AH 1K	1st Valve with Valve Guide & Valve Guide Rod.	
	M 611AH 2K	2nd valve with Valve Guide & Valve Guide Rod.	
	M 611AH 3K	3rd Valve with Valve Guide & Valve Guide Rod.	
13	S 677 N	Valve Guide Rod, nickel-plated.	
14	Z 1222	Valve Guide.	
15	P 310	Valve Spring.	
16	Z 1205	Valve Spring Support.	
17	S 680 N	Valve Stem Plug, nickel-plated.	
18	G 004BE	Valve Stem Felt, Blue.	
19	X 129 N	Top Cap, nickel-plated.	
20	G 007BE	Top Cap Felt, Blue.	
21	X 121 KN	Finger Button complete with Pearl, nickel-plated.	
22	PERLET 13	Pearl Inlay.	
23	S 498 L	Waterkey Nipple.	
24	T 344 L	Waterkey Saddle.	
25	P 312	Waterkey Spring.	
26	KOREK VK 4*8.5	Waterkey Cork.	
27	S 063	Waterkey Screw, lacquer.	
28	VKV 032A	Waterkey Lever, lacquer.	
**	VKV 032A K	Waterkey Assy. complete (List # 25-28), lacquer.	
29	SN 611AH 1K	1st Slide complete, lacquer.	<i>Outer Tubing to be ordered separately.</i>
29a	O 092 L	1st Slide Bow.	
29b	HTA 010 P3 L	1st Slide Ferrule (1 of 2 pcs).	
29c	THE 037 M3 L	1st Slide Inner Tubing, short.	
29d	THE 040 M3 L	1st Slide Inner Tubing, long.	
30	THA 042 P3 L	1st Slide Outer Tubing, short.	
31	THA 047 P3 L	1st Slide Outer Tubing, long.	
32	SN 611AH 2K	2nd Slide complete, lacquer.	<i>Outer Tubing to be ordered separately.</i>
32a	O 007	2nd Slide Bow.	
32b	S 497 L	2nd Slide Bow Knob.	
32c	HTA 010 P3 L	2nd Slide Ferrule (1 of 2 pcs).	
32d	THE 033 M3 L	2nd Slide Inner Tubing (1 of 2pcs).	
33	THA 035 P3 L	2nd Slide Outer Tubing (1 of 2pcs).	
34	SN 611AH 3K	3rd Slide complete, lacquer.	<i>Outer Tubing to be ordered separately.</i>
34a	O 089 L	3rd Slide Bow.	
34b	HTA 010 P3 L	3rd Slide Ferrule (1 of 2 pcs).	
34c	THE 063 M3 L	3rd Slide Inner Tubing, short.	
34d	THE 120 M3 L	3rd Slide Inner Tubing, long.	
35	THA 068 P3 L	3rd Slide Outer Tubing, short.	
36	THA 123 P3 L	3rd Slide Outer Tubing, long.	
37	LS 611AH K	Tuning Slide complete, lacquer.	<i>Outer Tubing to be ordered separately.</i>
37a	O 092 L	Tuning Slide Bow.	
37b	HTA 010 P3 L	Tuning Slide Ferrule (1 of 2pcs).	
37c	THE 050 M3 L	Tuning Slide Inner Tubing, short.	
37d	THE 061 M3 L	Tuning Slide Inner Tubing, long.	
38	THA 055 P3 L	Tuning Slide Outer Tubing, short.	
39	THA 070 P3 L	Tuning Slide Outer Tubing, long.	
40	O 089 L	Connecting Bow.	
41	H 708 L	Connecting Ferrule (1 of 2pcs).	
42	U 611AH L	Mouthpiece Receiver, engraved with Model Number.	<i>For 10.2mm Mouthpiece Shank Diameter.</i>

43	DH 174 L	Mouthpipe.	
	ESO 611AH L	Mouthpipe complete with Mouthpiece Receiver.	
44	S 040	Cardholder Screw, lacquer.	
45	T 345 L	Cardholder Socket with Plate.	
46	F 019/1 L	Brace, Mouthpipe - to - Bell.	
47	PS 611AH L	Valve Casing Assy. without Slides.	<i>Valves to be ordered separately.</i>
	SP 611AH L	Valve Casing Assy. complete with Slides.	<i>Valves to be ordered separately.</i>
48	A AX 0370G MP L	Brace with Plates, 3rd Slide - to - 1st Slide.	<i>Brace Length to be specified.</i>
49	A CX 0060G MP L	Brace with Plates, Bell - to - Branch II.	<i>Brace Length to be specified.</i>
50	A CX 0080G MP L	Brace with Plates, Bell - to - Branch III.	<i>Brace Length to be specified.</i>
51	A AX 0080G MP L	Brace with Plates, Branch II - to - Branch III.	<i>Brace Length to be specified.</i>
52	A CX 0020G MP L	Brace with Plates, Bell - to - Tuning Slide.	<i>Brace Length to be specified.</i>
53	A AX 0060G MP L	Brace with Plates, Branch II - to - Tuning Slide.	<i>Brace Length to be specified.</i>
54	A AX 0140G MP L	Brace with Plates, 1st Slide - to - Tuning Slide.	<i>Brace Length to be specified.</i>
55	A AX 0090G MP L	Brace with Plates, 3rd Slide - to - Branch III.	<i>Brace Length to be specified.</i>
56	A AB 0060G MP L	Brace with Plates, Branch II - to - 2nd Valve Casing.	<i>Brace Length to be specified.</i>

Important:

1/ All metal parts polished and unlacquered, unless otherwise specified. Please specify desired finish, when ordering.

2/ Please indicate the Instrument's Model Number, when ordering.